

- ① Solar Panel
- ② Switch Button
- ③ Lamp Body
- ④ LED
- ⑤ PIR

Battery: Li-ion Battery  
Solar panel: Monocrystalline silicon  
Materials: ABS

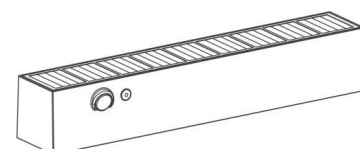
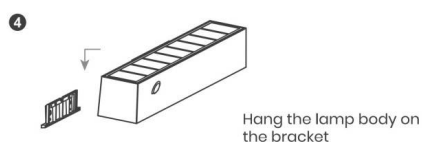
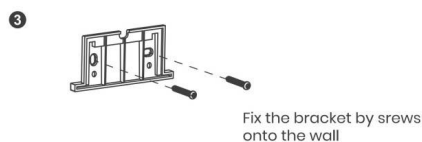
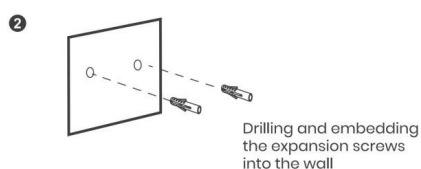
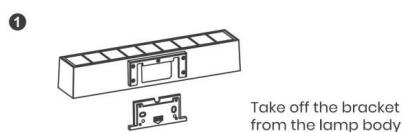

#### Switch Button

1. ON/OFF: Long press for 1.5S.  
(After the initial activation, the lamp will turn on/off automatically when dark/dawn.)
2. Change lighting mode: Short press.

#### Lighting Mode

- M1: 25% till dawn
- M2: 10%+PIR (30S)
- M3: 0+PIR (30S)
- M4: 100% till dawn